

# Neata<sup>®</sup>

+ Super energy

## Deep Cycle series

Datasheet : NTD12-100(12V100AH)

<b>Nominal Voltage</b>	12V
<b>Number of cell</b>	6
<b>Design Life</b>	10 years
<b>Nominal Capacity 77°F(25°C)</b>	
20 hour rate (5.0A, 10.5V)	100Ah
10 hour rate (9.50A, 10.5V)	95.0Ah
5 hour rate (217.5A, 10.5V)	87.5Ah
1 hour rate (66.2A, 9.6V)	66.2Ah
<b>Internal Resistance</b>	
Fully Charged battery 77°F(25°C)	≤5.7mOhms
<b>Self-Discharge</b>	
3% of capacity declined per month at 20°C(average)	
<b>Operating Temperature Range</b>	
Discharge	-20~60°C
Charge	-10~60°C
Storage	-20~60°C
<b>Max. Discharge Current 77°F(25°C)</b>	900(5s)
<b>Short Circuit Current</b>	2100A
<b>Charge Methods:</b> Constant Voltage Charge 77°F(25°C)	
<b>Cycle use</b>	2.40-2.45VPC
<b>Maximum charging current</b>	30.2A
<b>Temperature compensation</b>	-30mV/°C
<b>Standby use</b>	13.6-13.8V
<b>Temperature compensation</b>	-20mV/°C



Wide Range Temperature



Warranty



Maintenance Free



Deep cycle Technology



easy use



long life

### Mechanical Characteristics

Battery	mm±1	330×171×220
	inch	13.0×6.78×9.45
Box	mm±2	352×196×272
	inch	13.9×7.72×10.7
Quantity Per Box		1 PCS
Net weight Per Cell		31 Kg±150g
Net weight Per Box		31.0 Kg
Gross Weight		31.3 Kg

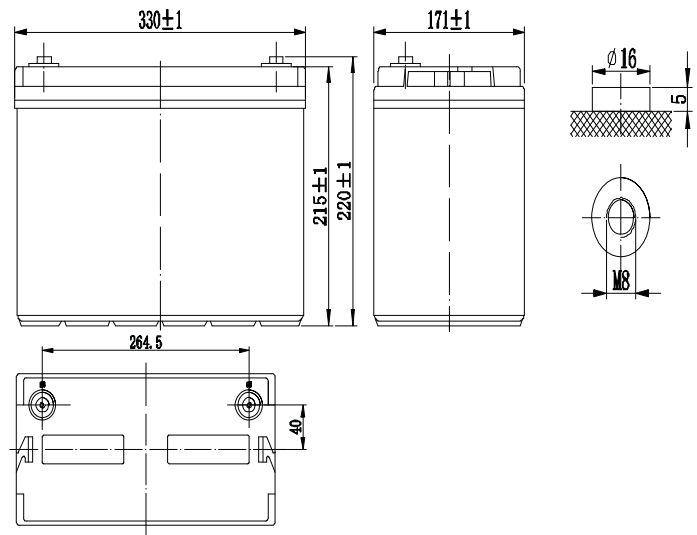

### Technical Characteristics

#### Discharge Constant Current (Amperes at 77°F25°C)

End Point										
Volts/Cell	10min	15min	30min	1h	3h	5h	10h	20h		
1.60V	220	180	105	65.2	27.6	18.9	9.75	5.20		
1.65V	212	173	101	61.6	27.4	18.2	9.70	5.15		
1.70V	192	159	93.6	60.6	26.9	17.9	9.65	5.10		
1.75V	180	148	90.7	59.6	26.6	17.4	9.60	5.05		
1.80V	168	139	88.7	56.5	25.1	17.1	9.50	5.00		

#### Discharge Constant Power (Watts at 77°F25°C)

End Point									
Volts/Cell	10min	15min	30min	45min	1h	2h	3h	5h	
1.60V	376	311	194	147	122	69.7	52.3	35.6	
1.65V	364	306	183	143	116	66.9	50.7	35.2	
1.70V	346	290	178	134	112	65.9	50.4	34.8	
1.75V	339	285	173	131	109	63.7	48.6	34.2	
1.80V	316	271	167	128	102	61.7	48.0	33.8	

(Note)The above characteristics data are average values obtained within three charge/discharge cycles. All data shall be changed without notice, Neata reserves the right to explain and update the information.

**SHENZHEN OFFICE (CHINA)**  
Tel: +86-755-2691-9474  
Fax: +86-755-2691-9474

Recognized under CE/ IEC and certified by ISO9001 ,14001



**Neata<sup>®</sup>** //Shenzhen Neata Power Tech co.,Ltd//www.neata-batt.com

# Neata<sup>®</sup> Deep Cycle series

Datasheet : NTD12-100(12V100AH)

+ Super energy

### Discharge Characteristics Curve

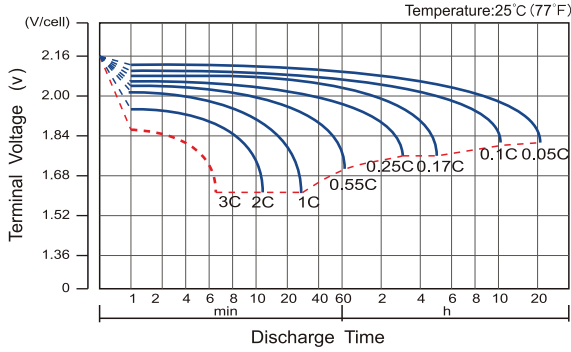

### Charge Characteristic Curve For Standby Use

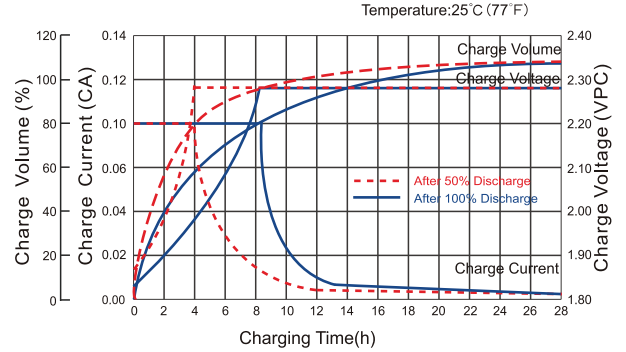

### Cycle Life In Relation To Depth Of Discharge

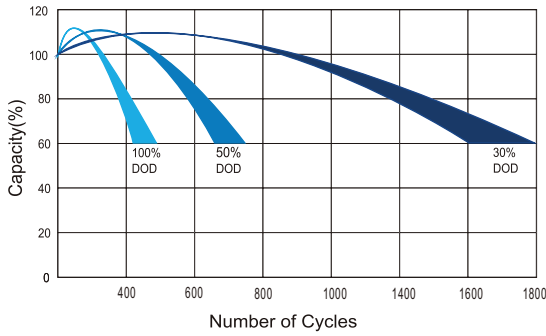

### Temperature Effects On Capacity

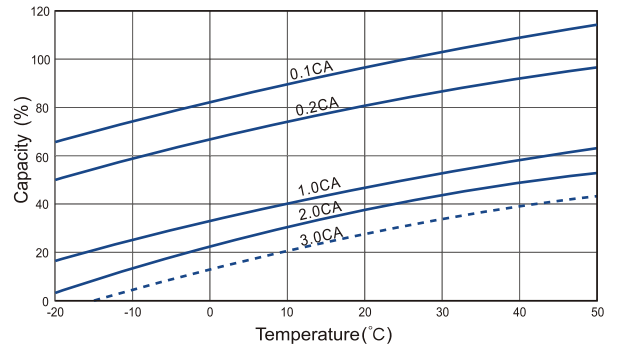

### Relationship Between Charging Voltage And Temperature

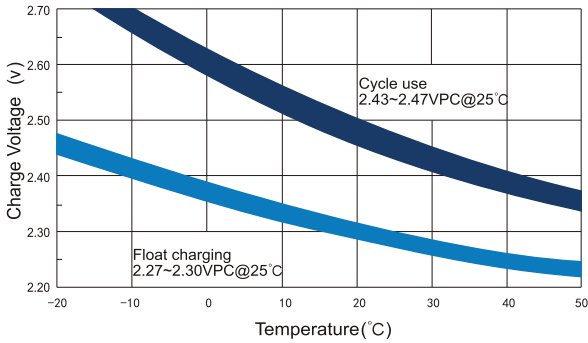

### Storage Characteristics

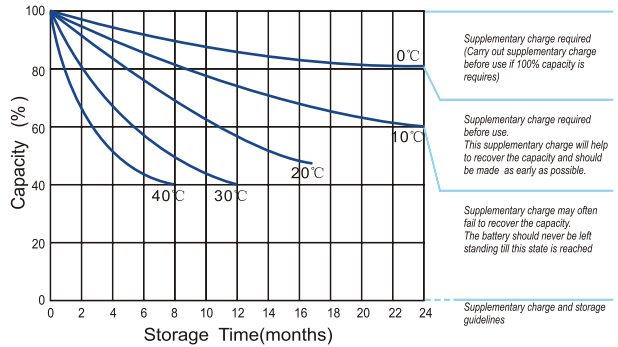

### Effect Of Temperature On Long Term Life

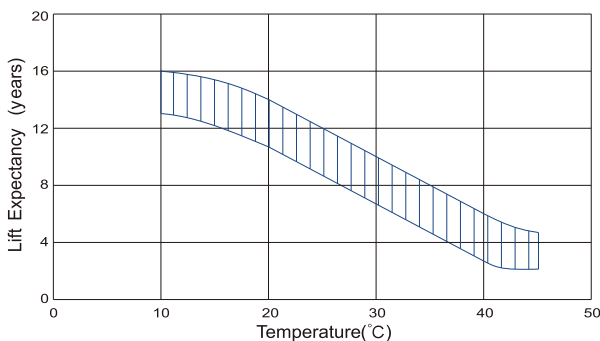

### Life Characteristics Of Standby Use

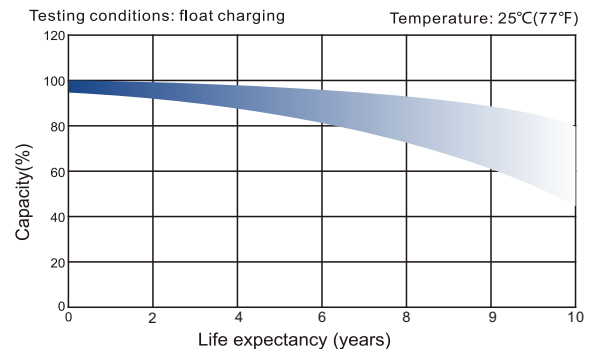

SHENZHEN OFFICE (CHINA)  
Tel: +86-755-2691-9474  
Fax: +86-755-2691-9474

Recognized under CE/IEC and certified by ISO9001,14001

